



3 km to KLCC

4 km to TRX

20 embassies nearby

108 units



— IMPRESSION —  
U-THANT





















FREEHOLD

Please contact us at : +6014 2069118  
Sales & Leasing : [www.EmbassyRow-Properties.com](http://www.EmbassyRow-Properties.com)  
Email : [Sales@RealEstate-MY.com](mailto:Sales@RealEstate-MY.com)

A Landmark of Executive Living  
in the Heart of KL City Center



# Facilities

-  Swimming Pool
-  Kid's Pool
-  Wading Pool
-  Aqua Gym
-  Jacuzzi
-  Indoor Gym
-  Outdoor Gym
-  Social Terrace
-  Cabana
-  Pilates/Yoga Deck
-  Pristine Lawn
-  Surau
-  Picnic Terrace
-  Sunset Bar
-  Viewing Deck
-  BBQ Pavilion
-  Community Farming Garden
-  Foot Reflexology
-  Convenient Shop
-  Poolside Party Pavilion



Sunset Bar

The 1.2-acre freehold Impression U-Thant comprises 10-storey condominiums and the built-up of the condominiums ranges from 782 sq ft to 1,632 sq ft for 108 units of six different types of layout. Impression U-Thant captures the essence of a traditional lifestyle with a modern twist, in the form of the innovative architectural designs, dual-key features and amenities.

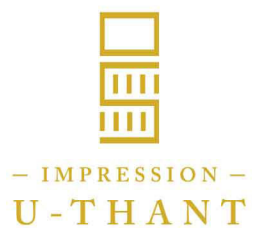

Aqua Gym



# Room Types



**A1**



1 Room  
782 sq ft

**A**



2+1 Rooms  
931 sq ft

**B**

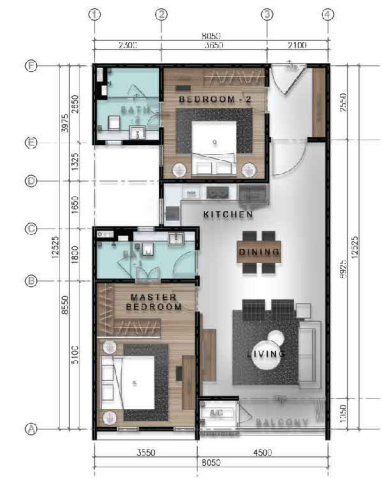

2 Rooms  
1012 sq ft

**D1**



2+1 Rooms  
1076 sq ft

**C**



3 Rooms  
1259 sq ft

**D**

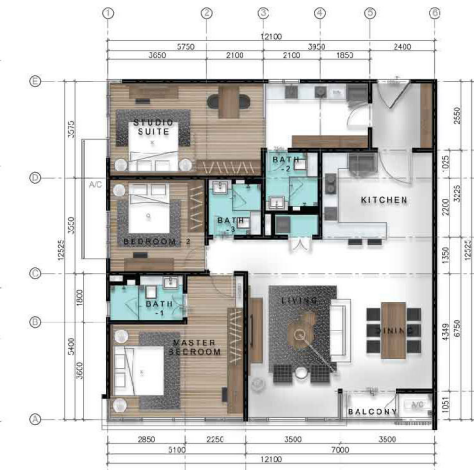

3 Rooms  
1632 sq ft

# Uniqueness



Smart Home System



Dual Key



Prime Location in the Heart of KL



Exclusive Low Density



Overseeing Royal Selangor Golf Club



Embassy Area



Easy Access - Jalan Tun Razak



20 Facilities Available



Master Bedroom - Type A

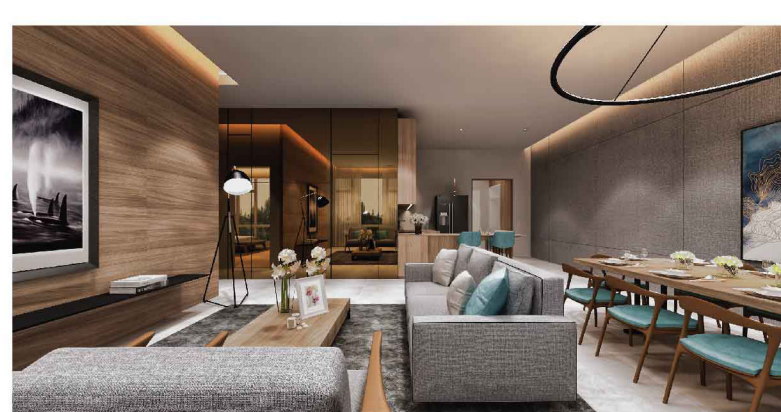

Living Room - Type D